

TIMING BELT PINIONS/INTEGRAL SHAFT

20° PRESSURE ANGLE

32 PITCH 3/16 FACE
1/4 SHAFT

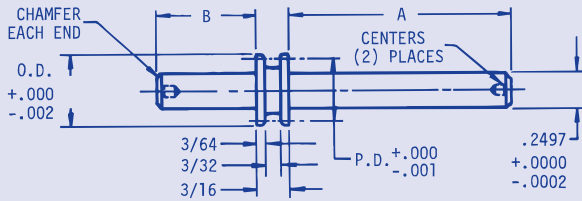

Material: 303 Stainless Steel. Finish: Clear passivate. *on application

No. Teeth	A	B	P.D.	O.D.	Overall Length	Cat. No.
14	3.000	-	.4375	.5000	3-3/16	FLS-D3-14
15			.4687	.5312		FLS-D3-15
16			.5000	.5625		FLS-D3-16
14	1.500	1-1/2	.4375	.5000	3-3/16	FLS-D9-14
15			.4687	.5312		FLS-D9-15
16			.5000	.5625		FLS-D9-16

TIMING BELT CLUSTER PULLEY

FOR USE WITH HUBLESS PULLEYS OR GEARS

32 PITCH
1/4 FACE
1/8 TO 1/4 BORE

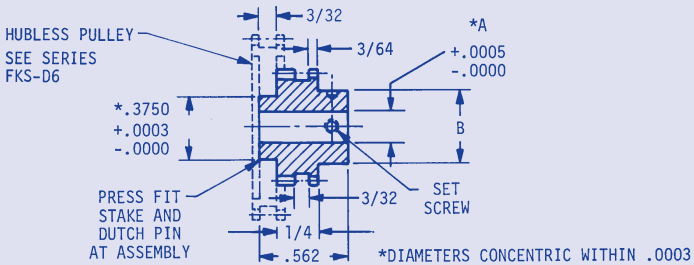

Material: 303 Stainless Steel. Finish: Clear passivate.

No. Teeth	A	B	P.D.	O.D.	Set Screw	Cat. No.
14	.1248	5/16	.4375	.5000	#2-56	FMS-D1-14
15			.4687	.5312		FMS-D1-15
16			.5000	.5625		FMS-D1-16
14	.1875	3/8	.4375	.5000	#4-40	FMS-D2-14
15			.4687	.5312		FMS-D2-15
16			.5000	.5625		FMS-D2-16
14	.2498	1/2	.4375	.5000	#4-40	FMS-D3-14
15			.4687	.5312		FMS-D3-15
16			.5000	.5625		FMS-D3-16

For special geometries or materials - price on receipt of print or sketch.

31F (800) 243-0986
In CT (203) 775-4877

NORDEX