

TIMING BELT PULLEYS

5 MM PITCH Hi-Torque & Precision
Tooth Profile

**FOR BELTS
9, 15, 25MM WIDE**

PowerGrip® GT Series

Material: Steel

Other sizes available - consult factory

Finish: Oiled

2 Set screws at 90°

Dimensions in inches.

Not for use with standard FQX series 5 mm belts.

See FMX-J5, K6 & L6 Series for 5MM pitch GT belts.

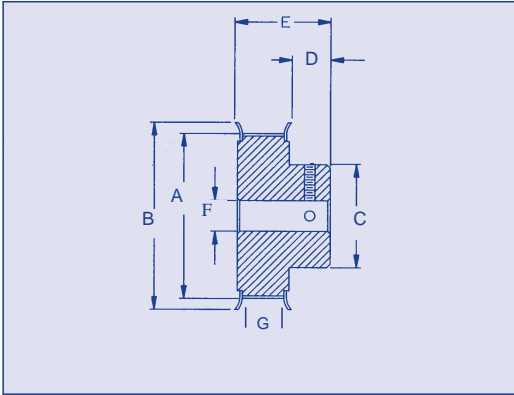

Cat. No.	No. of Grooves	Pitch Diameter	Bore +.001 - .000 F	O.D. A	Flange O.D. B	Hub Diameter C	Shoulder Width D	Overall Length E	Distance between flanges G
FMC-A1-18	18	1.128	.250	1.083	1.385	.68	.36	1.25	.69 (FMC-A1) for 9MM & 15MM
FMC-A2-18	18	1.128	.250	1.083	1.385	.68	.37	1.65	
FMC-A1-19	19	1.191	.250	1.146	1.420	.88	.36	1.25	
FMC-A2-19	19	1.191	.250	1.146	1.420	.88	.37	1.65	
FMC-A1-20	20	1.253	.250	1.208	1.510	.90	.36	1.25	
FMC-A2-20	20	1.253	.250	1.208	1.510	.90	.37	1.65	
FMC-A1-21	21	1.316	.250	1.271	1.530	.90	.36	1.25	
FMC-A2-21	21	1.316	.250	1.271	1.530	.90	.37	1.65	
FMC-A1-22	22	1.379	.250	1.334	1.530	.94	.39	1.28	
FMC-A2-22	22	1.379	.250	1.334	1.530	.94	.40	1.68	
FMC-A1-23	23	1.441	.375	1.396	1.660	1.15	.39	1.28	
FMC-A2-23	23	1.441	.375	1.396	1.660	1.15	.40	1.68	
FMC-A1-24	24	1.504	.375	1.459	1.780	1.18	.39	1.28	
FMC-A2-24	24	1.504	.375	1.459	1.780	1.18	.40	1.68	
FMC-A1-25	25	1.586	.375	1.521	1.780	1.18	.39	1.28	
FMC-A2-25	25	1.586	.375	1.521	1.780	1.18	.40	1.68	
FMC-A1-26	26	1.629	.375	1.584	1.900	1.21	.39	1.28	1.08 (FMC-A2) for 25MM
FMC-A2-26	26	1.629	.375	1.584	1.900	1.21	.40	1.68	
FMC-A1-28	28	1.754	.500	1.709	2.020	1.37	.45	1.34	
FMC-A2-28	28	1.754	.500	1.709	2.020	1.37	.45	1.73	
FMC-A1-30	30	1.880	.500	1.835	2.130	1.53	.45	1.34	
FMC-A2-30	30	1.880	.500	1.835	2.130	1.53	.45	1.73	
FMC-A1-32	32	2.005	.500	1.960	2.130	1.55	.45	1.34	
FMC-A2-32	32	2.005	.500	1.960	2.130	1.55	.45	1.73	
FMC-A1-34	34	2.130	.500	2.085	2.380	1.69	.45	1.34	
FMC-A2-34	34	2.130	.500	2.085	2.380	1.69	.45	1.73	
FMC-A1-36	36	2.256	.500	2.211	2.380	1.69	.45	1.34	
FMC-A2-36	36	2.256	.500	2.211	2.380	1.69	.45	1.73	
FMC-A1-38	38	2.381	.500	2.336	2.610	1.96	.45	1.34	
FMC-A2-38	38	2.381	.500	2.336	2.610	1.96	.45	1.73	
FMC-A1-40	40	2.506	.500	2.461	2.730	2.09	.49	1.38	
FMC-A2-40	40	2.506	.500	2.461	2.730	2.09	.50	1.78	

O.D. Tolerances - Inches:
18-32 Grooves +.003/ -.000
34-40 Grooves +.004/ -.000